

MOOR THE BOAT

what to know and how to do

USE SHACKLES

Always fix the mooring to the pontoon and to the boat with Shackles enough big to have them always free to rotate. In this case when the stress came they can allign theyr self with the stress direction.

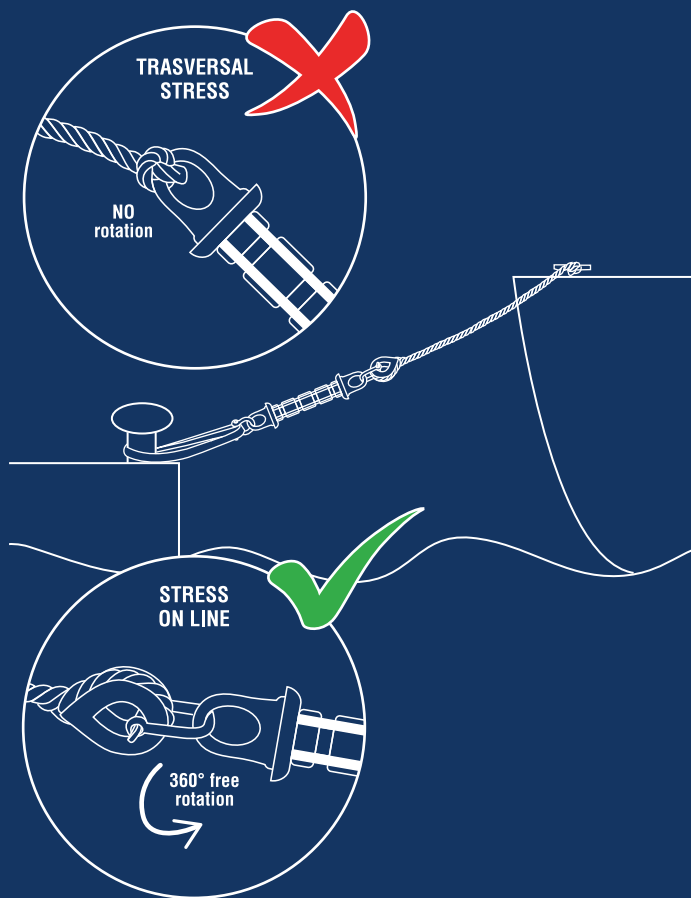

FIX THE BOW

The boat need to have the bow well fixed to the dead body in order that the aft mooring ropes nevere get enough soft to let the mooring spring to get in touch with the pontoon.

NEVER HAVE TO TOUCH PONTOON

The moorings never have to touch pontoon; that means that the chain or the mooring belt have to be enough long to keep them away from the pontoon also when the boat is not pulling.

